

Typical Drainage Wall using CavClear® Insulation System

Product Overview

The CavClear® Insulation System features the CavClear® Masonry Mat factory bonded to rigid insulation. It is installed full-height behind brick and stone in an insulated masonry wall to provide a continuous drainage area.

A properly functioning drainage system is the prerequisite for a masonry design to achieve maximum thermal efficiencies and reduced maintenance and repair costs. Mortar obstructions and droppings which impede drainage are completely prevented by installing full-height protection using CavClear® Insulation System.

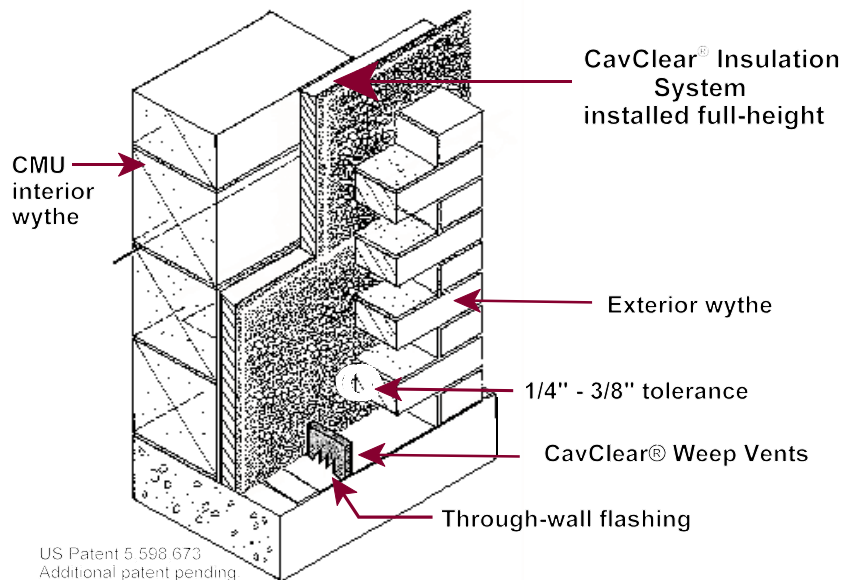

Key Benefits

- Helps prevent mold, mildew and other moisture-related failures.
- One-step, fail-safe installation to eliminate weep obstructions and ensure a continuous drainage path.
- Prevents mortar bridges, minimizing thermal and moisture transfers between the wythes.
- Reduces material costs by substantially reducing mortar waste.
- Reduces long-term life-cycle costs by maximizing thermal efficiencies and reducing maintenance and repair.
- Assures proper drainage even when a smaller-than-desired cavity width is necessary due to project requirements.

Dimensions

The CavClear® Insulation System is available with a variety of insulation types and any thickness CavClear® Masonry Mat ($\frac{1}{2}$ ", $\frac{3}{4}$ ", 1", $1\frac{1}{4}$ ", $1\frac{3}{4}$ ").

CavClear® Insulation System is sized to 16"x96" to fit easily between joint reinforcement. Also available in 4'x8' sheets.

A $\frac{1}{4}$ " to $\frac{3}{8}$ " tolerance between the CavClear® Masonry Mat and the masonry veneer allows finger space and variation in actual airspace dimension. When ordering or specifying the CavClear® Insulation System, please indicate both the thickness of the Mat and the insulation as well as the insulation type (extruded Type IV, extruded Type X, polyisocyanurate, EPS, etc) and dimension.

One-Step Installation

Easy installation makes this the ultimate airspace maintenance and drainage system. Masons simply install insulation in typical manner as brickwork is completed.

Installation Directions

- Install CavClear® Insulation System continuously in exterior masonry cavities during construction of the exterior wythe.
- Install horizontally between wall ties or joint reinforcement.
- Stagger end joints in adjacent rows.
- Butt adjacent pieces to moderate contact.
- Fit to perimeter construction and penetrations without voids.
- A compatible foam joint sealant is recommended at panel to panel joints, around perimeter and at penetrations.



The Clear Choice For Dependability

Contact Us

CavClear®/Archovations, Inc.
PO Box 241, Hudson, WI 54016
888-436-2620 • fax 715-381-9883

